

計画平面図 S=1:500



工種・種別・細別	規格・条件	単位	数量
落差工設計		式	1
落差工詳細設計		箇所	2
路線測量		式	1
作業計画		業務	1
現地踏査		km	0.04
横断測量		本	6

基準点座標値

点名	X座標	Y座標	標高
H30-2-1	125801.429	86475.475	7.900
H30-2-2	126378.156	86312.873	14.445
H30-3-1	126096.987	86383.950	11.838
T-1	125852.444	86457.132	9.261
T-2	125921.124	86442.643	9.908
T-3	125993.988	86436.083	10.698
T-4	126061.008	86405.239	11.364
T-5	126169.536	86370.042	12.587
T-6	126217.898	86339.182	13.158
T-7	126284.656	86315.619	13.826
T-8	126337.451	86323.355	14.367

設計業務箇所

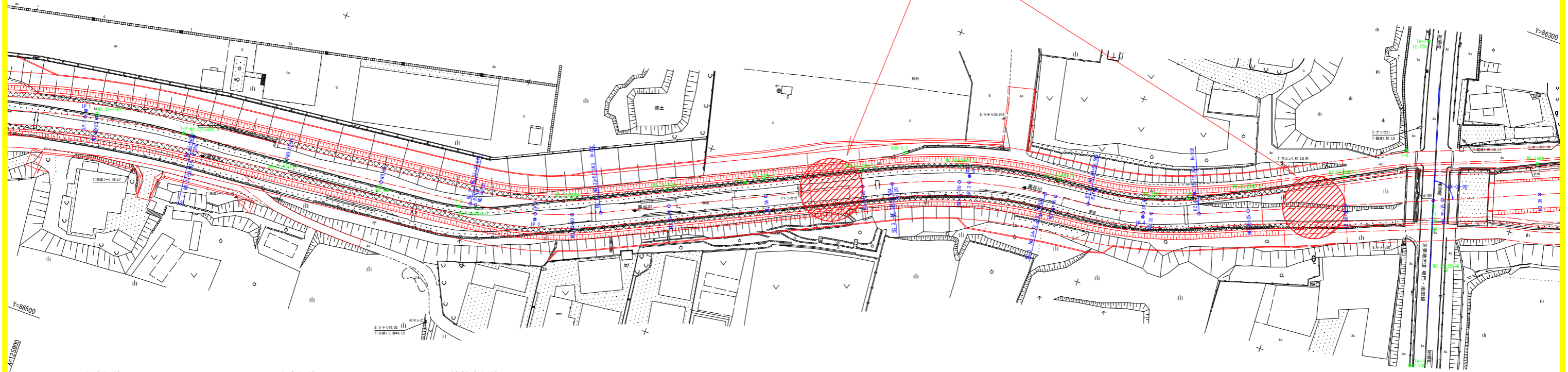

中間点座標値

点名	X座標	Y座標
BP	125849.841	86461.856
NO. 31+75	125850.973	86461.456
BC. 1	125868.418	86455.297
NO. 32	125874.574	86453.214
SP. 1	125895.811	86447.351
NO. 32+25	125898.701	86446.707
NO. 32+50	125923.357	86442.642
EC. 1	125923.930	86442.577
NO. 32+75	125948.203	86439.869
NO. 33	125973.049	86437.097
BC. 2	125996.547	86434.476
NO. 33+25	125997.895	86434.317
SP. 2	126013.067	86431.207
NO. 33+50	126022.056	86428.156
EC. 2	126028.804	86425.211
NO. 33+75	126044.698	86417.567
NO. 34	126067.228	86406.731
NO. 34+25	126089.758	86395.895
BC. 3	126096.637	86392.586
NO. 34+50	126112.776	86386.216
SP. 3	126115.144	86385.501
EC. 3	126134.565	86381.558
NO. 34+75	126137.233	86381.243
BC. 4	126145.769	86380.234

中間点座標値

点名	X座標	Y座標
SP. 4	126159.883	86377.526
NO. 35	126161.829	86376.984
EC. 4	126173.464	86372.823
NO. 35+25	126185.076	86367.840
NO. 35+50	126208.051	86357.982
NO. 35+72.70	126228.911	86349.031
NO. 35+75	126231.025	86348.125
NO. 36	126253.999	86338.267
BC. 5	126273.012	86330.108
NO. 36+25	126276.988	86328.442
SP. 5	126298.585	86320.749
NO. 36+50	126300.562	86320.154
NO. 36+75	126324.847	86314.260
EC. 5	126325.023	86314.227
NO. 37	126349.410	86309.603
NO. 37+25	126373.972	86304.947
NO. 37+26.80	126375.741	86304.611
EP	126376.216	86304.521

控杭座標値

点名	X座標	Y座標
NO. 35+67.00	126223.673	86351.279
NO. 37+5.00	126354.322	86308.672
EPR9. 5	125846.678	86452.898
NO. 31+75R9. 5	125847.810	86452.498
NO. 32R2. 7	125873.742	86450.646
NO. 32+25R1. 1	125898.468	86445.632
NO. 32+50R0. 5	125923.300	86442.145
NO. 32+75L0. 5	125948.258	86440.366
NO. 33L1	125973.160	86438.091
NO. 33+25L0. 5	125997.957	86434.813
NO. 33+50R4	126020.592	86424.433
NO. 33+75R4. 3	126042.834	86413.692
NO. 34R4. 3	126065.364	86402.856
NO. 34+25R4. 3	126087.894	86392.020
NO. 34+50R4. 5	126111.431	86381.922
NO. 34+75R4. 5	126136.705	86376.774
NO. 35R4	126160.717	86373.142
NO. 35+25R5. 3	126182.986	86362.969
NO. 35+50R7. 5	126205.094	86351.090
NO. 35+75L18	126238.123	86364.667
NO. 36R8	126250.844	86330.915
NO. 36+25R9	126273.582	86320.111
NO. 36+50R10	126297.721	86310.566
NO. 36+75R10	126322.977	86304.436
NO. 37R9. 5	126347.640	86300.269
NO. 37+25L9	126375.648	86313.789
NO. 37+26.80L9	126377.417	86313.453

IP	IP間方向角	IA	R	曲 TL	線 SL	表 CL	IP間距離	X座標	Y座標
BP	340-33-14						48.363	125849.841	86461.856
IP. 1	353-38-04	13-04-50	250.000	28.662	1.638	57.075	118.751	125895.445	86445.755
IP. 2	334-18-52	19-19-12	100.000	17.022	1.438	33.720	112.315	126013.464	86432.589
IP. 3	353-15-36	18-56-44	120.000	20.022	1.659	39.679	45.788	126114.681	86383.908
IP. 4	336-46-36	16-29-00	100.000	14.484	1.044	28.769	150.163	126160.153	86378.534
IP. 5	349-15-52	12-29-17	250.000	27.353	1.492	54.489	79.458	126298.149	86319.322
EP								126376.216	86304.521

工事名	R1徳土 黒谷川 板・那東 落差工詳細設計業務		
路線名等	黒谷川		
工事箇所	板野郡板野町那東		
図面名	計画平面図		
縮尺	1:500	図面番号	1 / 1
会社名			
事業者名	徳島県東部県土整備局<徳島>		